

Product No.	System Power*	LED Lumen	Beam Angle	Colour Temp	CRI	Driver
709063.000	17.5W	2100Lm	40°	4000K	80+	500mA



■ Product Features

- G316 grade Stainless steel trim with flush safety glass and diecast aluminium recessed body
- IP67 / IP68 1M, Static Force 20KN and IK10 protection
- 20° Cutoff
- 40° reflector fitted as standard
- 10°/20°/70° reflectors available on request
- Supplied complete with efficient heat sink and integral electronic LED driver
- Supplied complete with 1m connection cable for wiring to junction box
- Supplied complete with plastic pre-install housing
- Available with Square trim to order
- *Connected electrical loads are rated values and subject to a tolerance of +/- 10%

■ Product Dimensions

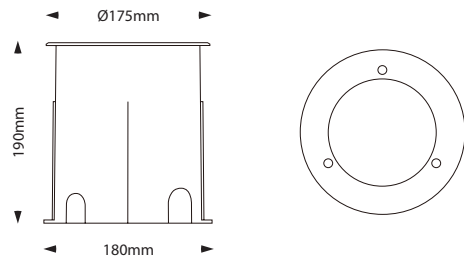

■ Reflector Polar Curve

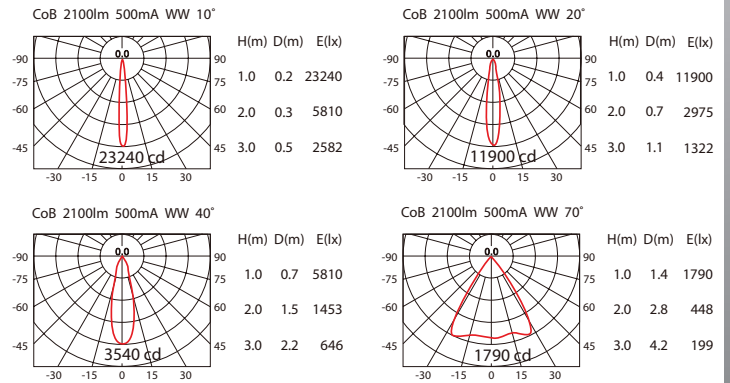

■ Product Standard



■ Product Options



■ Optional Accessories

