

Product No.	System Power*	LED Module	Beam Angle	Mounting	Colour Temp	CRI	Driver
405109.000	29W	3000Lm (25.6W)	Indirect	Surface Mounted	4000K	80+	1050mA



LIGHTSOURCE BY
XICATO®

■ Product Features

- High quality die cast aluminium and stainless steel
- Bayonet locking head with locking grub screw
- Protection rated IP54
- Flat fixed symmetric top reflector, underside high reflectance satin white for diffused wide and glare free light distribution
- Supplied complete with highly efficient heat sink and electronic LED driver
- Complete with 3S Ø136mm x 3.3m pole
- Clear safety glass
- Finish: 3S Silver as Standard
- *Connected electrical loads are rated values and subject to a tolerance of +/- 10%

■ Product Dimensions

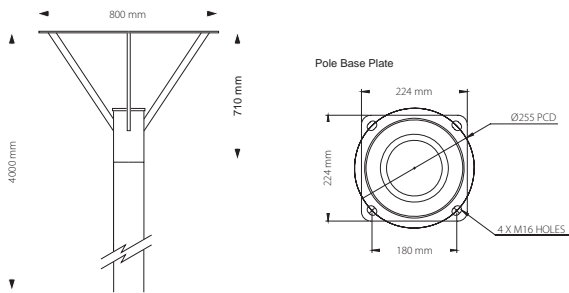

■ Reflector Polar Curve

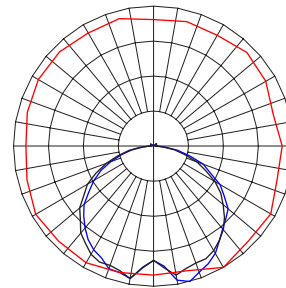

■ Product Standard



■ Product Options



■ Luminaire Specification

Product No.	Beam Angle	LED Module	LED Output	System Power	Colour Temp	Driver	Trim Colour
405109.XYZ	INDIRECT	<input type="checkbox"/> XTM STD (CRI 80+)	1300lm	11.4W	<input type="checkbox"/> 2700K	<input type="checkbox"/> NON-DIM	<input type="checkbox"/> 3S SILVER
		<input type="checkbox"/> XTM STD (CRI 80+)	2000lm	18,24W	<input type="checkbox"/> 3000K	<input type="checkbox"/> DALI	<input type="checkbox"/> 3S BLACK
		<input type="checkbox"/> XTM STD (CRI 80+)	3000lm	29.4W	<input type="checkbox"/> 3500K		<input type="checkbox"/> CUSTOM
					<input type="checkbox"/> 4000K		

■ Luminaire Configuration

Connectivity Casambi Tridonic basicDIM Wireless XICATO GalaXi

■ Luminaire Information

LED Module	Standard XTM19*		
CRI	80+*		
LED Lumen	1300lm	2000lm*	3000lm
Current	700mA	700mA*	1050mA
Typical LED Wattage	9.5W	15.2W*	25.6W
LED Efficacy	137lm/W	131lm/W*	117lm/W
Overall Height "H"	710mm	710mm*	710mm

"XYZ" - Part No. to be advised by 3S Lighting based on the combination of configurable options selected
A.XYZ - "A" of the Part No. determined by the beam angle selected

* Standard product specification

■ Project Information

Project Name:		Type:	
Quantity:		Expected Due Date:	
Client's Name:		Date of Issue:	
Notes:		Signature:	

■ XICATO Light Source



Initial Colour Consistency: ≤ 1 x 2 MacAdam Ellipses (SDCM) at 70°C, B0
Lumen Maintenance: L70/B0 at 50,000 hours

Colour Maintenance: Consistency maintained < 0.003 Δu'v' at 50,000 hours

Warranty: 5 years for individual modules (B0) on mortality, color and lumen maintenance.

Standard XTM19 Excellent, natural colour rendition with high efficiency.

Designer XTM19 An optimal balance between accurate, natural colour rendition, lumen output and efficacy.

Artist XTM19 The most accurate, natural colour rendition possible, over the entire visual spectrum.

[... click for more information](#)

■ APPs (with XID / TBW driver only)



CASAMBI, Tridonic basicDim Wireless and XICATO GalaXi

Lighting control solutions provide for all the control options that are expected from a full featured professional lighting control solution, Apps available for both iOS and Android.

[... click for more information](#)